

# EMP INDI

## Aluminium profile for LED strips

### Perfil de aluminio para tiras LED

-  Anodized  
Anodizado
-  \*Black Anodized  
Negro Anodizado
-  \*Pintado Blanco  
White Painted
-  \*On request  
Bajo pedido





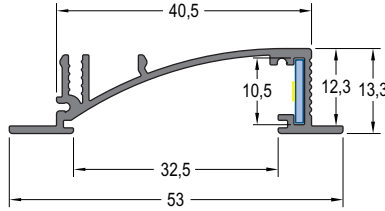

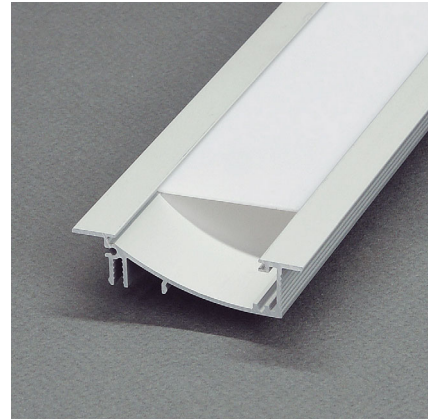

For LED strips up to Para tiras LED hasta	10 mm
Installation Instalación	Recessed Empotrado

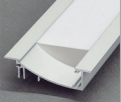
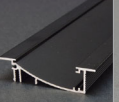

Blue rectangle shows the space for the LED strip  
El rectángulo azul muestra el espacio para la tira de LED



Profile / Perfil			Covers / Difusores	
				
Anodized Anodizado	Black anodized Negro Anodizado	White Painted Pintado Blanco	Opal Opal	Transparent Transparente
				
Ref. No.	Ref. No.	Ref. No.	Ref. No.	Ref. No.
eDEC EI-20-A	eDEC EI-20-B	eDEC EI-20-W	eDEC DI-EI-20-OP	eDEC DI-EI-20-TR
9955325	9955326	9955327	9955335	9955337

This profile can be installed with or without cover. Without cover, the profile makes an interesting indirect light effect.

*Este modelo puede ponerse con o sin difusor. Sin difusor hace un efecto muy interesante de luz indirecta.*



- ~ EMP INDI: Aluminium profile with 40,5 mm section for recessed installations in plasterboard walls. Provides an indirect light effect.
- ~ Mounting: Stick the LED strip into the included aluminium heat sink plate and insert trough the profile.
- ~ Fixing:
  - ~ With installation profile FIJ (see page 171).
  - ~ With optional accessories (see table below).
- ~ Standard length: 2000 mm. For other lengths we can make custom size.
- ~ eDEC DI-EI-20: Lateral insertion.

- ~ EMP INDI: Perfil de aluminio con sección de 40,5 mm para empotrar en paredes de escayola o cartón-yeso. Proporciona un efecto de luz indirecta.
- ~ Montaje: Pegar la tira LED en la placa disipadora de aluminio incluida e insertar por la ranura del perfil.
- ~ Fijación:
  - ~ Con perfil de instalación FIJ (ver página 171).
  - ~ Con accesorios opcionales (ver tabla inferior).
- ~ Longitud estándar: 2000 mm. Para otras longitudes se pueden realizar cortes a medida.
- ~ eDEC DI-EI-20: Inserción lateral.

Packaging and weight p. 191 and [www.elt.es/productos/packaging\\_EL.T.pdf](http://www.elt.es/productos/packaging_EL.T.pdf)

Embalaje y peso pág. 191 y [www.elt.es/productos/embalaje\\_EL.T.pdf](http://www.elt.es/productos/embalaje_EL.T.pdf)

#### Accessories / Accesorios

	Model Modelo	Ref. No.	Units Uds.	Remarks Observaciones
<b>Endings</b> Tapas 	eDEC TA-EI-G (Grey / Gris)	9955330	2	Without hole / Sin agujero
	eDEC TA-EI-B (Black / Negro)	9955331		Ending thickness increases the length of the profile El espesor de la tapa final aumenta la longitud del perfil
	eDEC TA-EI-W (White / Blanco)	9955332		
	eDEC TA-EI-S (Silver / Plata)	9955333		
<b>Flexible mounting plates</b> Placas de montaje flexible 	eDEC PM-135-FL	9955245	2	Clic-mounting for surface or recessed installation. Easy uninstal. Screws including. Recommended 2-4 pcs/m. Fijación mediante clic en instalación en superficie o empotrada. Fácil desinstalación. Tornillos incluidos. Recomendado 2-4 uds/m.
<b>Fixed mounting plates</b> Placas de montaje fijas 	eDEC PM-135-FI	9955244	2	Clic-mounting for surface or recessed installation. Screws including. Recommended 2-4 pcs/m. Fijación mediante clic en instalación en superficie o empotrada. Tornillos incluidos. Recomendado 2-4 uds/m.

	Model Modelo	Ref. No.	Units Uds.	Remarks Observaciones
<b>Union plates</b> Placas de unión 	eDEC PU-135	9955246	1	Clic-mounting for surface or recessed installation. Screws including. Strengthen with eDEC PM-135-FL or eDEC PM-135-FI. Placa para montar y unir dos perfiles. Fijación mediante clic en instalación en superficie o empotrada. Tornillos incluidos. Reforzar con eDEC PM-135-FL o eDEC PM-135-FI.
	eDEC PM-135-M	9955247		Mounting plate with springs Placa de montaje con muelles

